





County Courthouse, OH
Peri-mittari series: S3061
Photo credit: Stacey Herron Photography



peri-mittari

perimeter

When it is the expression of light that is important and not seeing the luminaire itself, Peri-mittari, by PMC Lighting, has the lighting solution. Peri-mittari excels at offering a myriad of perimeter lighting solutions to showcase your space. Whether you need to illuminate a vaulted ceiling or graze a textured wall surface, we design a lighting system tailored for your application. Made in our factory in the United States, we customize lengths, ceiling integrators, diffusers and finishes to offer the ideal combination of form and function to enhance your architectural space.



County Courthouse, OH
 Peri-mittari series: S3061
 Photo credit: Stacey Herron Photography

Wallwashing Perimeter Systems

Peri-mittari offers multiple sizes and configurations of linear systems to illuminate the wall surface. For wallwashing applications, consider the models displayed here.

These systems emphasize even illumination of the wall surface and contribution of lighting into the general ambient space. Most luminaires in this category utilize reflectors, hidden lamp(s) and an open aperture.



SLC White Acrylic Reflector Wallwash



S3061 White Acrylic Reflector Wallwash



S175 Semi-Specular Open Reflector Wallwash



SPI Indirect Reflector Wallwash



County Courthouse, OH
Peri-mittari series: S3061
Photo credit: Stacey Herron Photography



County Courthouse, OH
 Peri-mittari series: SPWW-CD
 Photo credit: Stacey Herron Photography

Wallslot Perimeter Systems

Peri-mittari offers multiple sizes and configurations of linear systems to illuminate the wall surface. For wallslot applications, consider the models displayed here.

These systems provide direct light source highlighting/accenting the wall surface. Functionally they graze the wall surface and are characterized by frequent use of architectural diffusers including lenses, louvers and cross blades.

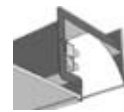

SPS-SR Open Reflector Wallslot



SPS-CD Ceiling Level Diffuser Wallslot



SPS-RPL Cantilevered Parabolic Louver Wallslot

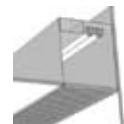

SPWW Steel Perimeter Wallslot multiple diffusers



S3075 Steel Regressed Lens Wallslot



E3095 Extruded Aluminum Regressed Lens Wallslot

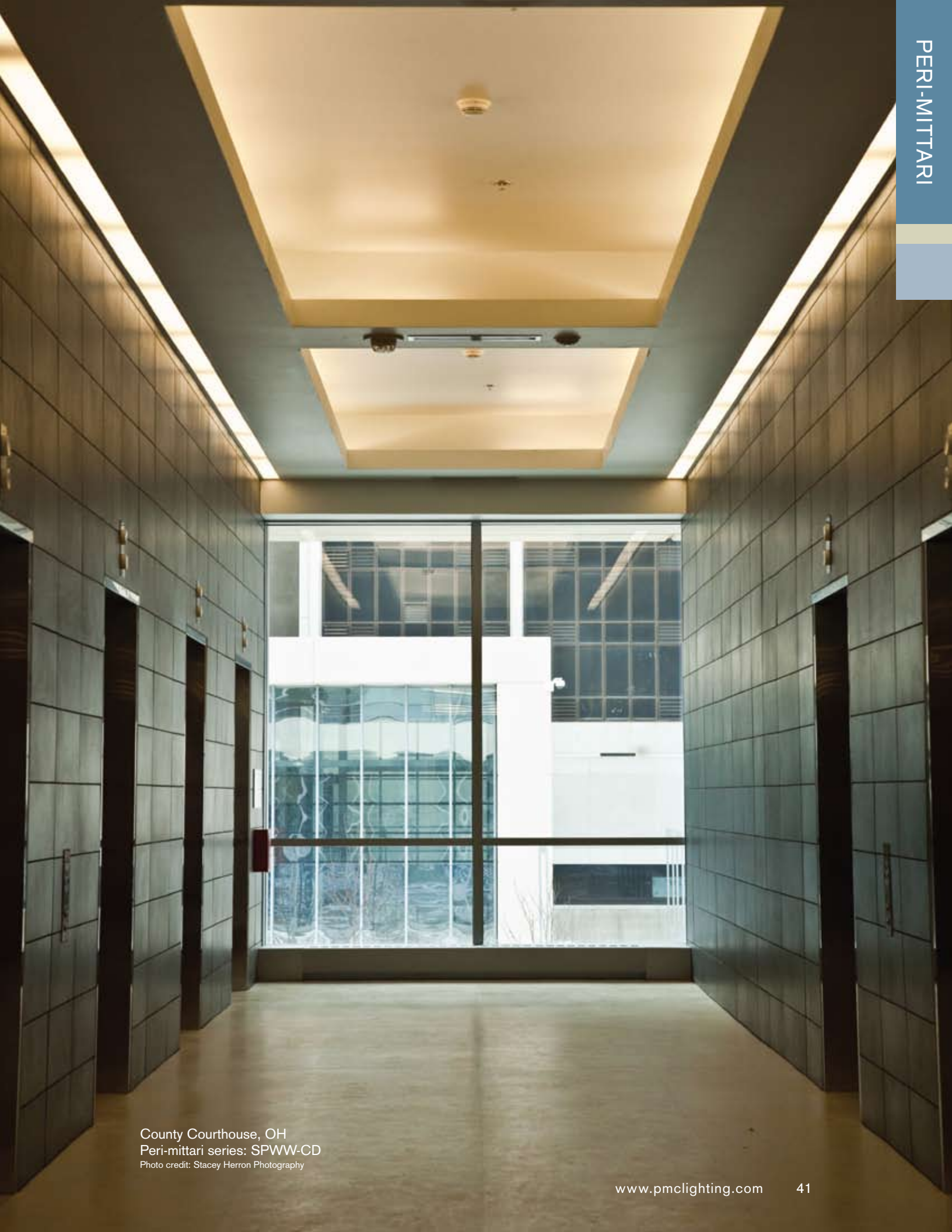

County Courthouse, OH
Peri-mittari series: SPWW-CD
Photo credit: Stacey Herron Photography



Cove Series

Peri-mittari addresses the cove application with multiple options, sizes and lamp configurations from which to choose. They include:

SC Series: Steel Cove Indirect

When the cove is already built out, we provide the optical performance. With an adjustable feature, our asymmetric distribution can be customized in the field for optimal lighting performance.

SCCS Series: Steel Concealed Cove Surface

Whether wall or cove mounted, this series provides all the performance of the SC series but in its own complete clean low profile housing. Standard finish is white, custom finishes are available. Consult factory for details.



SC5626
Steel Cove
Wide Indirect



SC85-AI
Asymmetric
Rotatable Indirect

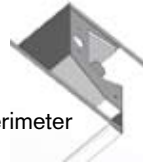

S3070
Steel Perimeter
Indirect



SCCS
Concealed
Cove Indirect



SCCS-LP
Concealed Cove
Indirect Low Profile



SCC-RK
Concealed Cove
Multi-angle Indirect



County Courthouse, OH
Peri-mittari series: S3061
Photo credit: Stacey Herron Photography



County Courthouse, OH
 Peri-mittari series: S3061
 Photo credit: Stacey Herron Photography

To order a Peri-mittari product, select product data from each category below. Consult specification sheets available on our website – www.pmclighting.com to confirm availability of specific combinations of features and options.

MODEL NUMBER

1 – Series	2 – Output	3 – Mounting	4 – Lamp/Type	5 – Length	6 – Diffuser	7 – Finish	8 – Voltage	9 – Options
------------	------------	--------------	---------------	------------	--------------	------------	-------------	-------------

1 – Series:

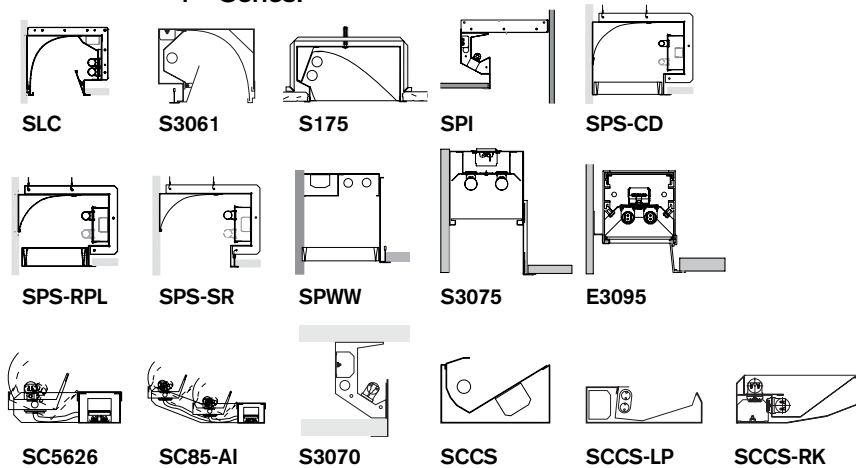

Wallwashing Series:

- SLC White Acrylic Reflector Wallwash
- S3061 White Acrylic Reflector Wallwash
- S175 Semi-Specular Open Reflector Wallwash
- SPI Indirect Reflector Wallwash

Wallslot Series:

- SPS-CD Ceiling Level Diffuser Wallslot
- SPS-RPL Cantilevered Parabolic Louver Wallslot
- SPS-SR Open Reflector Wallslot
- SPWW Steel Perimeter Wallslot multiple diffusers
- S3075 Steel Regressed Lens Wallslot
- E3095 Extruded Aluminum Regressed Lens Wallslot

Cove Series:

- SC5626 Steel Cove Indirect
- SC85-AI Asymmetric Rotatable Indirect
- S3070 Steel Perimeter Indirect
- SCCS Concealed Cove Indirect
- SCCS-LP Low Profile Cove Indirect
- SCCS-RK Multiangle Indirect

Peri-mittari specification data:

Our Peri-mittari series showcases products for all perimeter illumination applications whether they are washing or grazing the wall surface through direct illumination or projecting light onto the ceiling through indirect illumination.

2 – Output:

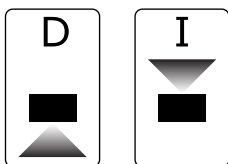

3 – Mounting:

Recessed (T=T-bar and FL=Flanged)
 W/T—Wall T-bar adapted
 W/FL—Wall Flanged adapted for dry-wall ceiling
 S—Surface
 W—Wall mounted

4 – Lamping Quantity & Type: (1/2) T5 / T5HO / T8 / Biax

5 – Lengths: 2'/3'/4'/6'/8' Nominal lengths, custom lengths available

6 – Diffusers:

P12—Prismatic lens
 PBL—Semi-specular parabolic louver
 PL1—1/2 silver paracube
 PL2—3/4 silver paracube
 PL3—1 1/2 silver paracube
 WB—White cross blade louver
 WB/PERF—Perforated white cross blade louver
 WOA—White opal acrylic lens
 O—Open

Reflectors:

WHT—Standard White
 MWA—Matte White Acrylic
 SS—Semi-specular
 PR—Parabolic Reflector Diffuser

7 – Color:

Finishes—Fixture finish is white polyester powder coated paint standard.
 WHT (White) CA (Custom Finish)

8 – Voltage:

120/277/347

9 – Options:

DIM—Dimming, consult factory
 EM—Emergency, consult factory
 GLR—Fusing
 DC—Dust cover
 2CIR—2 circuit wiring
 W2W—Wall to wall build-out

Construction / Materials:

Recessed housing and surface mounted fixtures are die-formed heavy gauge cold rolled steel unless extruded aluminum indicated. Internal components are standard white high-gloss enamel with a minimum 90% reflectivity. Standard housing finish is white. Custom colors available.

Labels—UL, CUL listed for damp location.

All fixtures are pre-wired and individually tested with electronic ballasts standard.

Data provided for general information. Consult product specification sheets at www.pmclighting.com for availability of specific combinations of features and options, full technical specifications and photometric data.

Sample photometry for typical Peri-mittari series:

To access our complete photometric data for this series, visit our website at www.pmcighting.com.

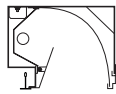
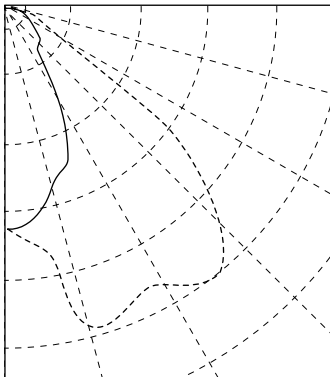

SLC-D-T-1/T8-4'
(1) 2950 Lumen Lamp

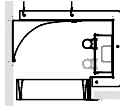
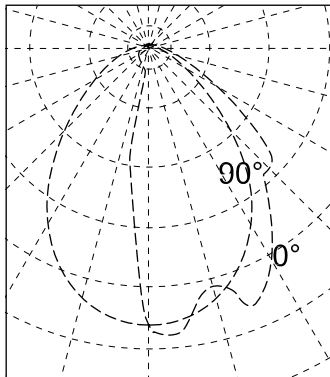

SPS-RPL-T-2/T8-PBL
(2) 2950 Lumen Lamps

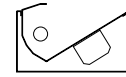
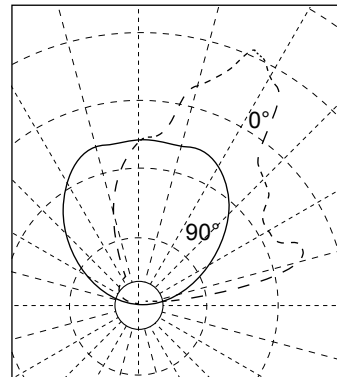

SCCS-1T8
(1) 2950 Lumen Lamp