

# SYLINTERI





Center for the Visual Arts, NC  
Sylinteri series: S-FLV6



# SYLINTERI

## *cylinder*

As the perfect companion to our recessed downlighting line, Sylinteri literally goes where our recessed offering cannot. Sylinteri responds to those difficult applications where plenum access is limited, high ceiling planes where luminaires are inaccessible or simply applications where a visual lighting element is desired. Sylinteri offers a fully integrated series with LED, metal halide and compact fluorescent sources in a myriad of ceiling and wall mounted configurations. Rely on PMC to provide the full range of sources, sizes and configurations ideally suited to the needs of your application.

Sylinteri offers many shapes, sizes and configurations in the sources that you need for today's applications.

**Choose from:**

**Surface Mounted Cylinder**

In the purest form, the surface mounted cylinder model offers multiple lamp sources, distribution patterns, sizes and configurations creating a seamless transition from our recessed offering.

**Pendant Cylinder**

Converting the surface series to a pendant is practical for those high ceiling applications and offers dramatic interest as well. Swivel Pendant option also available for sloped ceiling applications.

**Yoke Adjustable**

Our yoke mounted cylinders are adjustable in both the horizontal and vertical planes making them easy to aim, project and control the lighting distribution pattern. The yoke mounted adjustable cylinder is ideal for accent lighting and/or hard to illuminate applications.

**Wall Bracket Cylinder**

Offered in all the same configurations, the wall mounted cylinder is ideally suited for perimeter illuminations, columns or canopies.

Consult factory for indirect or direct/indirect applications.



**Surface Mounted**



**Pendant**



**Yoke Adjustable**



**Wall Bracket**



Edgewater Lounge at BC Place, Vancouver, BC  
Sylinteri series: S-FLV



Fair Park, Natick, MA  
Sylinteri series: W-FLV8



Center for the Visual Arts, NC  
Syinteri series: S-FLV6

To order a Syinteri product, select product data from each category below. Consult specification sheets available on our website – [www.pmclighting.com](http://www.pmclighting.com) to confirm availability of specific combinations of features and options.

#### MODEL NUMBER

1 – Light Source	Aperture	2 – Mounting	3 – Lamp	4 – Reflector	5 – Lens/ Diffuser	6 – Finish	7 – Voltage	8 – Options
------------------	----------	--------------	----------	---------------	-----------------------	------------	-------------	-------------

#### 1 – Series:

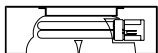

CFL Horizontal  
Cylinder

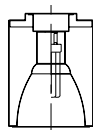

CFL Vertical  
Cylinder

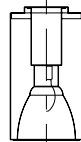

Metal Halide  
Cylinder

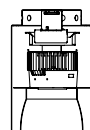

LED Cylinder

FLH6—6" Aperture CFL Horizontal  
FLH8—8" Aperture CFL Horizontal  
FLH9—9" Aperture CFL Horizontal  
FLH10—10" Aperture CFL Horizontal  
FLV6—6" Aperture CFL Vertical  
FLV8—8" Aperture CFL Vertical  
FLV10—10" Aperture CFL Vertical

OMH8—8" Metal Halide ED17  
MHP8—8" Metal Halide Par 38/30  
MHT6—6" Metal Halide T4/T6  
MHT8—8" Metal Halide T6

6LEC—6" Cylinder LED; 1100-1700LM  
6LEC-PO—6" Cylinder LED; 1300-1560LM  
6LEC-HP—6" Cylinder LED; 1100-3000LM  
6LEC-XL—6" Cylinder LED; 1100-3000LM

## Sylinteri specification data:

PMC showcases one of the deepest product lines for cylinder luminaires available in the market today. The Sylinteri series offers breadth of product coupled with the most innovative lamp technology.

**2 – Mounting:** S—Surface W—Wall Mounted  
P—Pendant Y—Adjustable Yoke Mounted

**3 – Lamping:** Fluorescent: Metal Halide:  
PLT/QPL (1/2/3) 13w 20w/39w—T4  
(1/2/3) 18w 39w/70w/150w—T6  
(1/2/3) 26w 70w/100w/150w—Par 38  
(1/2/3) 32w 50w/70w/100w/150w/175w—ED17  
(1/2/3) 42w  
(1) 57w LED:  
(1) 70w 550 Lumens—3000 Lumens  
Kelvin temps: 2700 to 4000 K

**4 – Reflectors:**



Trims: Low iridescent spectacular Alzak Reflectors in colors shown.

**5 – Diffusers/Baffle:** O—Open FCA—Frosted Clear Acrylic  
P12—Prismatic Acrylic lens PB4—4-Cell Parabolic Louver  
C73—Corning 73 glass MB—Micro Baffle (BLK/ BRZ/ WHT)  
WOA—White Opal Acrylic CGS—Clear Glass Shield

**6 – Finish:** Finishes—Polyester powder coated paint over pre-treated surface.  
W=White / B=Black / BR=Bronze Standard  
Custom finishes are available.

**7 – Voltage:** 120/277/347

**8 – Options:** DIM—Dimming, consult factory EM—Emergency, consult factory for integral or remote  
GLR—Fusing EMQ—Quartz Re-strike (Metal Halide)  
2CIR—2 circuit wiring C—Contact factory for custom requests

**Construction / Materials:**

Open heavy gauge aluminum cylinder. Wall bracket—one piece extruded aluminum arm finished to match cylinder. Louvers and lenses as indicated.

**Electrical:** Pulse-rated porcelain socket. Pre-wired.

**Labels**—UL & CUL listed suitable for damp location. Consult factory for UL Wet.  
All fixtures are pre-wired and individually tested with electronic ballasts standard.

Data provided for general information. Consult product specification sheets at [www.pmcighting.com](http://www.pmcighting.com) for availability of specific combinations of features and options, full technical specifications and photometric data.

# Sample photometry for typical Sylinteri series:

To access our complete photometric data for this series, visit our website at [www.pmcighting.com](http://www.pmcighting.com).

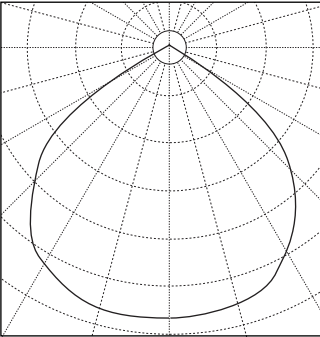

**SS-FLH-8-2/13QPL-CL**  
(2) 900 Lumen Lamps

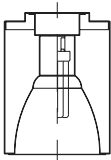
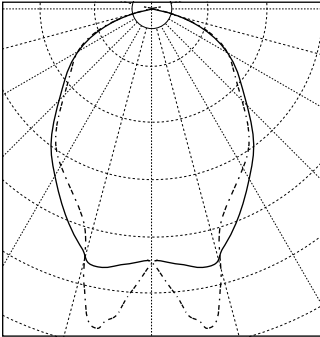

**S-FLV-8-32PLT-CL**  
(1) 2400 Lumen Lamp

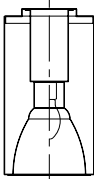
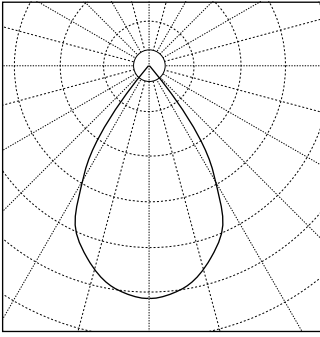

**SOMH-8-70ED17-CL**  
(1) 5900 Lumen Lamp